

PVA- 01K to 013

SANITARY STERILE AIR/GAS/ STEAM FILTER VESSEL

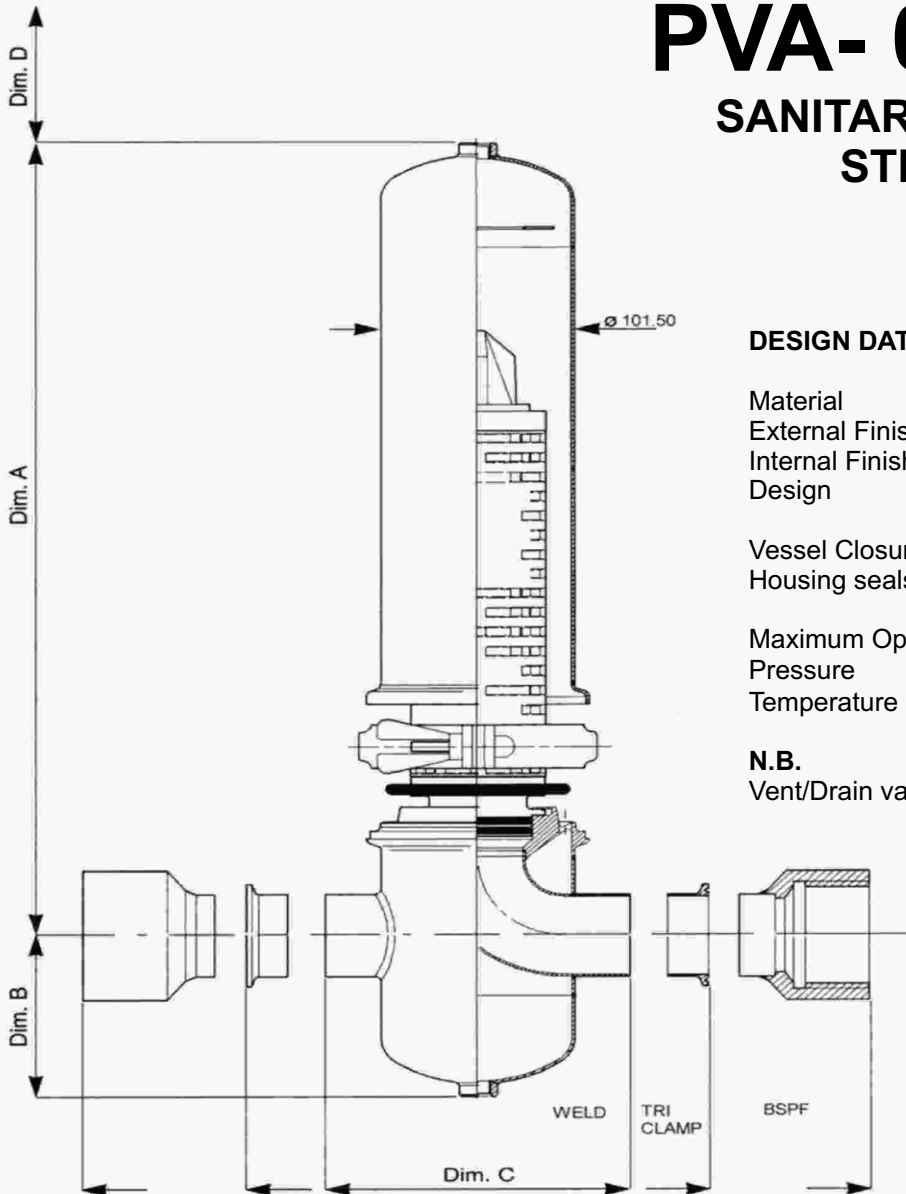

DESIGN DATA

Material : 316 Stainless Steel
 External Finish : Mechanically mirror polished
 Internal Finish : Electropolished (0.6 M)
 Design : Generally in accordance with ASME VIII Div.1 (1989)
 Vessel Closure : V Band Clamp
 Housing seals : Silicon

Maximum Operating Conditions :
 Pressure : 7.0 kg/cm²
 Temperature : 145 °C

N.B.

Vent/Drain valves must be ordered separately.

Vessel Code	No.&Size of Cartridge Fitment	Connections		Dimensions (mm)				Approx. Weight (kgs)
		Inlet / Outlet	Vent / Drain	A	B	C	D	
PVA-01K-CWE	1x125 (5")	50mm (2") Weld	6mm (1/4") BSP	265	85	180	150	3.5
PVA-01K-CTE	1x125 (5")	50mm (2") Triclamp	6mm (1/4") BSP	265	85	180	150	3.5
PVA-01K-CBE	1x125 (5")	50mm (2") BSPP	6mm (1/4") BSP	265	85	260	150	3.5
PVA-011-CWE	1x250 (10")	50mm (2") Weld	6mm (1/4") BSP	430	85	180	300	4.1
PVA-011-CTE	1x250 (10")	50mm (2") Triclamp	6mm (1/4") BSP	430	85	180	300	4.1
PVA-011-CBE	1x250 (10")	50mm (2") BSPP	6mm (1/4") BSP	430	85	260	300	4.1
PVA-012-CWE	1x500 (20")	50mm (2") Weld	6mm (1/4") BSP	680	85	180	550	5.6
PVA-012-CTE	1x500 (20")	50mm (2") Triclamp	6mm (1/4") BSP	680	85	180	550	5.6
PVA-012-CBE	1x500 (20")	50mm (2") BSPP	6mm (1/4") BSP	680	85	260	550	5.6
PVA-013-CWE	1x750 (30")	50mm (2") Weld	6mm (1/4") BSP	930	85	180	800	7.1
PVA-013-CTE	1x750 (30")	50mm (2") Triclamp	6mm (1/4") BSP	930	85	180	800	7.1
PVA-013-CBE	1x750 (30")	50mm (2") BSPP	6mm (1/4") BSP	930	85	260	800	7.1

ProAir

Shah Pneumatics

28-30, Navketan Industrial Estate,
 Mahakali Caves Road, Andheri (East),
 Mumbai 400 093 INDIA
 Tel : +91-22-66951090
 Fax : +91-22-26875317
 email : shahpneu@bom3.vsnl.net.in
 website : www.shah-pneumatics.com